

HabasitLINK[®]

M3843 Tight Radius 1.5"



Your Source For Habasit
Belting And Chain

www.StilesEnterprises.com • 1-800-325-4232

Description

- For radius and straight conveying, ideal for applications with limited space (collapse factor 1.6)
- 37% open area; 50% open contact area; largest opening 9x18 mm (0.35"x0.7")
- Excellent for cooling and draining
- Easy to clean
- Food approved materials available
- Rod diameter 6 mm (0.24")
- "Open window" sprockets

Available accessories

- Flights: Minimum indent 105 / 95 mm (4.1" / 3.7")
- Sideguards
- Hold down modules

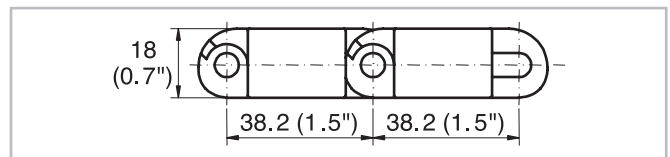

Belt data

Belt material		PP		POM	
Rod material		POM		PA	
Nominal tensile strength F'_N straight run	N/m	20000	20000	29000	
	lb/ft	1370	1370	1986	
Nominal tensile strength F'_N in curve ⁽¹⁾	N	1800	1800	2250	
	lbf	405	405	506	
Temperature range	°C	5 - 93	5 - 105	-40 - 93	
	°F	40 - 200	40 - 220	-40 - 200	
Belt weight m_B	kg/m ²	8.0	8.0	11.8	
	lb/sqft	1.64	1.64	2.42	

⁽¹⁾ For $b_0 > 600$ mm (23.6") higher values admissible. Refer to LINK-SeleCalc.

Diameter of idling rollers (minimum)		Diameter of support rollers (minimum)		Diameter for gravity take-up and center drive rollers (minimum)		Backbending radius for elevators without sideguards or hold down devices (minimum)		Backbending radius for elevators with sideguards or hold down devices (minimum)	
mm	inch	mm	inch	mm	inch	mm	inch	mm	inch
60	2.4	100	4	150	6	150	6	250	10

Use the largest possible backbending radius for elevators with side guards or hold down devices.